

RI-Clamps (Clamps with Rubber Insert)

STANDARD-SERIES

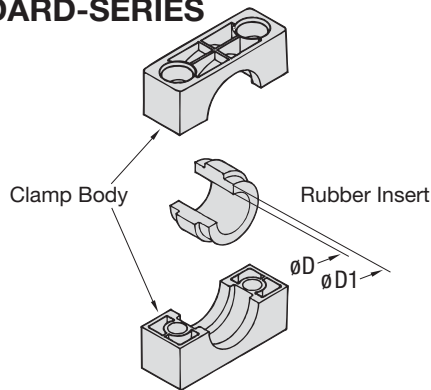

HEAVY-SERIES

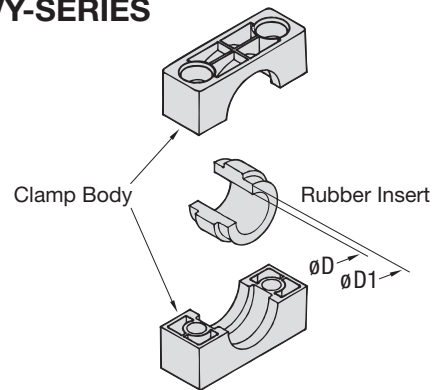

STAUFF Group	DIN Group	Pipe-O.D.		Order Code		
		ØD [mm]	ØD1 [mm]	Rubber Insert	Clamp Body	Rubber Insert + Clamp Body
4	4	6	25,5	RI 406	4 xxR	406 xxR
		8		RI 408	4 xxR	408 xxR
		10		RI 410	4 xxR	410 xxR
		12		RI 412	4 xxR	412 xxR
		12,7		RI 412,7	4 xxR	412,7 xxR
		14		RI 414	4 xxR	414 xxR
		15		RI 415	4 xxR	415 xxR
		16		RI 416	4 xxR	416 xxR
		17,2		RI 417,2	4 xxR	417,2 xxR
		18		RI 418	4 xxR	418 xxR
19	RI 419	4 xxR	419 xxR			
6	6	20	39	RI 620	6 xxR	620 xxR
		21,3		RI 621,3	6 xxR	621,3 xxR
		22		RI 622	6 xxR	622 xxR
		25		RI 625	6 xxR	625 xxR
		26,9		RI 626,9	6 xxR	626,9 xxR
		28		RI 628	6 xxR	628 xxR
		30		RI 630	6 xxR	630 xxR
		32		RI 632	6 xxR	632 xxR

Other O.D. on request.

STAUFF Group	DIN Group	Pipe-O.D.		Order Code					
		ØD [mm]	ØD1 [mm]	Rubber Insert	Clamp Body	Rubber Insert + Clamp Body			
4S	2	06	25,5	RI 4006	4S xxR	4006 xxR			
		08		RI 4008	4S xxR	4008 xxR			
		10		RI 4010	4S xxR	4010 xxR			
		12		RI 4012	4S xxR	4012 xxR			
		12,7		RI 4012,7	4S xxR	4012,7 xxR			
		14		RI 4014	4S xxR	4014 xxR			
		15		RI 4015	4S xxR	4015 xxR			
		16		RI 4016	4S xxR	4016 xxR			
		17,2		RI 4017,2	4S xxR	4017,2 xxR			
		18		RI 4018	4S xxR	4018 xxR			
		19		RI 4019	4S xxR	4019 xxR			
		5S		3	20	39	RI 5020	5S xxR	5020 xxR
21,3	RI 5021,3		5S xxR		5021,3 xxR				
22	RI 5022		5S xxR		5022 xxR				
25	RI 5025		5S xxR		5025 xxR				
26,9	RI 5026,9		5S xxR		5026,9 xxR				
28	RI 5028		5S xxR		5028 xxR				
30	RI 5030		5S xxR		5030 xxR				
32	RI 5032		5S xxR		5032 xxR				
6S	4		32		65		RI 6032	6S xxR	6032 xxR
			33,7				RI 6033,7	6S xxR	6033,7 xxR
			35				RI 6035	6S xxR	6035 xxR
			38,7				RI 6038,7	6S xxR	6038,7 xxR
		40	RI 6040	6S xxR		6040 xxR			
		42	RI 6042	6S xxR		6042 xxR			
		45,5	RI 6045,5	6S xxR		6045,5 xxR			
		48	RI 6048	6S xxR		6048 xxR			
		51	RI 6051	6S xxR		6051 xxR			
		53,4	RI 6053,4	6S xxR		6053,4 xxR			
56,4	RI 6056,4	6S xxR	6056,4 xxR						
7S	5	55	89	RI 7055	7S xxR	7055 xxR			
		57		RI 7057	7S xxR	7057 xxR			
		60		RI 7060	7S xxR	7060 xxR			
		65		RI 7065	7S xxR	7065 xxR			
		70		RI 7070	7S xxR	7070 xxR			
		72		RI 7072	7S xxR	7072 xxR			
8S	6	80	116	RI 8080	8S xxR	8080 xxR			
		88,9		RI 8088,9	8S xxR	8088,9 xxR			

Other O.D. on request.

Clamp Body	Material XX
Polypropylene	PP
Polyamide	PA
Elastomer	Material
	Thermoplastic Elastomer (TPE) 70° Shore A

Attention!

For RI-clamps the relationship between the diameter and the group is not the same as in the Profile- or H-clamp.

Pipe Clamps For Industrial Electric Applications And Electric Cables

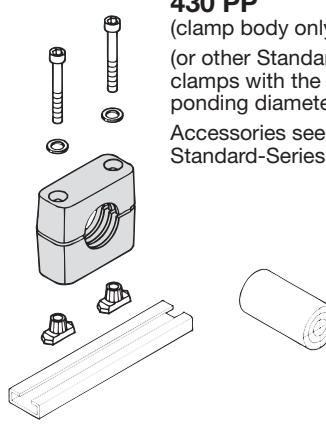
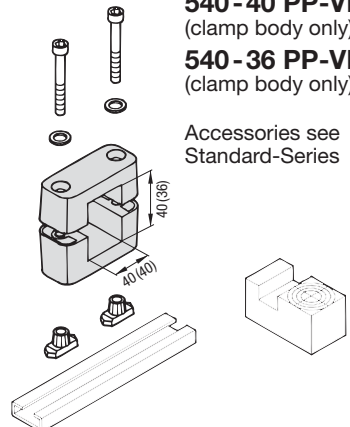
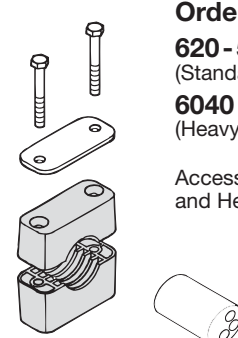
<p>Order Code 430 PP (clamp body only) (or other Standard-Series clamps with the corresponding diameter) Accessories see Standard-Series</p>  <p>For proximity switches acc. to EN 50008/50036/50040 or similar Proximity switch – round construction, 30 mm dia.-fastened with a Group 4 Standard-Series clamp mounted on mounting rail with hexagon rail nuts. Loosening of the bolts provides axial and horizontal position adjustment.</p>	<p>Order Code 540-40 PP-VK (clamp body only) 540-36 PP-VK (clamp body only) Accessories see Standard-Series</p>  <p>For proximity switches acc. to EN 50025/50037 Proximity switch – rectangular construction, 40 mm square-fastened with Group 5 Standard Duty clamp mounted on mounting rail with hexagon rail nuts. Loosening of the bolts provides axial and horizontal position adjustment.</p>	<p>Order Code 620-50 PP (Standard-Series) 6040-72 PP (Heavy-Series) Accessories see Standard- and Heavy-Series</p>  <p>For clamping of electric cables: STAUFF-Oval Clamps Group 6 Standard-Series for cable diameters between 20 and 50 mm. Group 6 S Heavy-Series for cable diameters between 40 and 72 mm. Bolt types: Standard-Series: Hexagon Head Bolt in conjunction with cover plate. Socket Cap Screw with washer Slotted Head Screw with washer. Heavy Series: Hexagon Head Bolt in conjunction with cover plate. For varying cable diameters only the bolt length needs to be varied.</p>
---	--	---

CRA C-RAIL-ADAPTOR

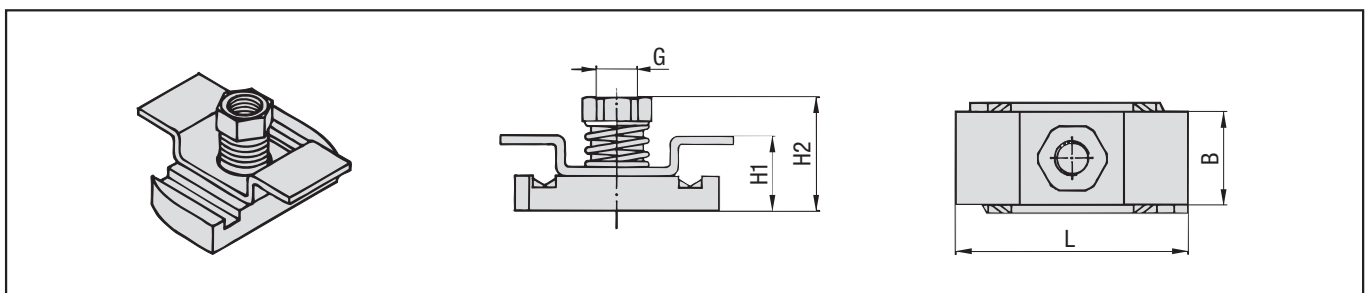

STAUFF Series	STAUFF Group	Thread G		Dimensions				Lengths of Bolts (for clamps with cover plates)	
		Metric	UNC	L	B	H1	H2	Metric	UNC
Standard	CRA 1-8	M6	1/4	40	16	13	20,5	see Standard-Series	see Standard-Series
Heavy	CRA 3S	M10	3/8	38	22	18,5	27,5	M10 x 40	3/8 x 1 1/2 UNC
	CRA 4S							M10 x 55	3/8 x 2 1/8 UNC
	CRA 5S							M10 x 65	3/8 x 2 5/8 UNC
	CRA 6S	M12	7/16	45	25	17	27,5	M12 x 100	7/16 x 4 UNC
Twin	CRA 1D	M6	1/4	40	16	13	20,5	M 6 x 35	1/4 x 1 UNC
	CRA 2D	M8	5/16	38	53	18,5	27,5	M 8 x 35	5/16 x 1 3/8 UNC
	CRA 3D							M 8 x 45	5/16 x 1 3/4 UNC
	CRA 4D							M 8 x 50	5/16 x 2 UNC
	CRA 5D							M 8 x 60	5/16 x 2 1/2 UNC

Material: Carbon Steel, zinc plated (Fe/Zn 8 B), Stainless Steel on request.

Information

The C-RAIL-ADAPTOR Type CRA is suitable for the following C-rails:

UNISTRUT-Rails
P1000, P1000T, P1000V, P1000VT, P1001
P2000, P2000T
P3003, P3003T, P3300V, P3300VT, P3301
P4000, P4000T
P5000, P5000T, P5001, P5500, P5500T, P5501

HALFEN-Rails
HM 41/41
HZA 41/22
HZM 41/41
HZM 41/22
HL 41/41, HL 41/B2

Order Code

CRA xx x

